

MILLARD FILLMORE HISTORICAL TRAIL  
MORAVIA, N.Y.

Nationally Approved  
  
**HISTORIC TRAILS**  
 BOY SCOUTS OF AMERICA

Cayuga County  
 Historian's Office  
 10 Court Street  
 Auburn, NY 13021

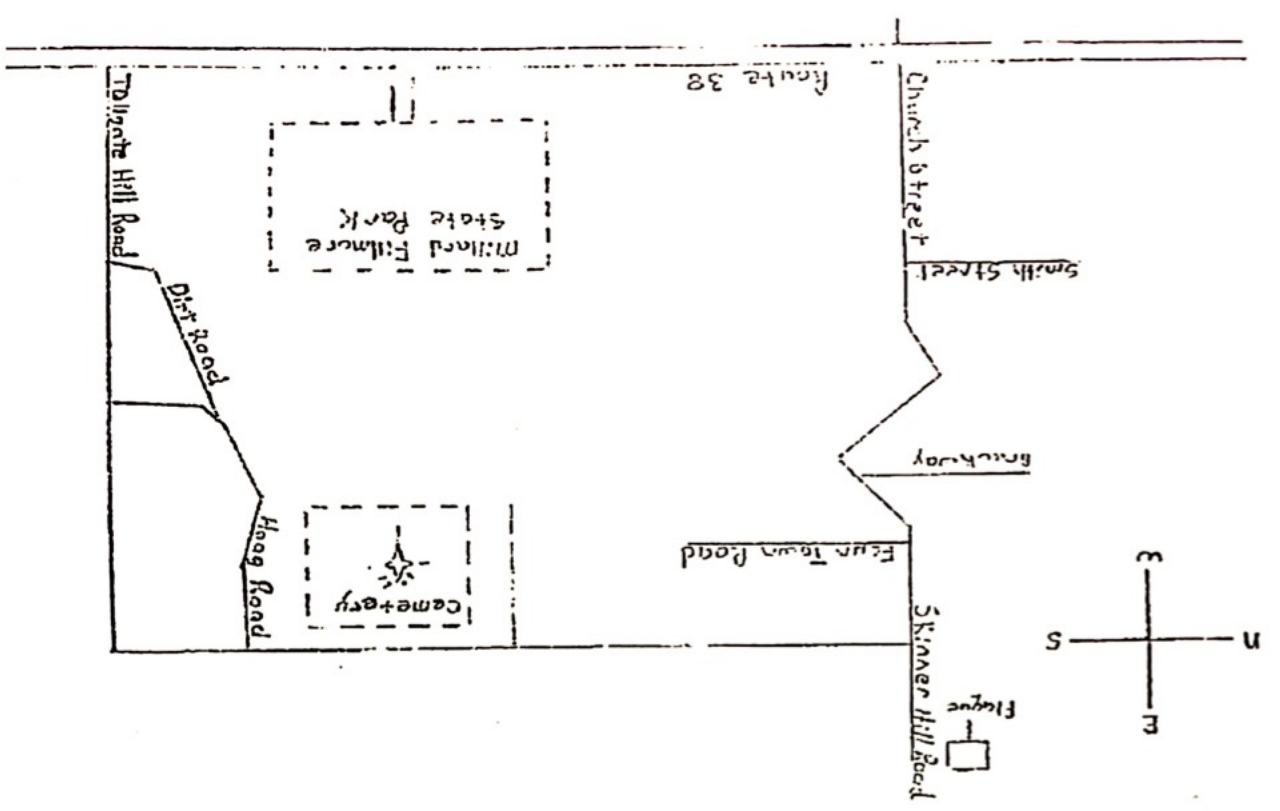

2. What does the marker say?

---

Retrace your route for .5 of a mile until you come to Lick Street. Turn left onto Lick Street and continue walking south. Along this road you will notice many old building foundations. During Fillmore's childhood there was a thriving community called Lickville on this road. After traveling 1 mile on Lick Street you will notice a road named Sun Lane to the right. On Sun Lane is located New York States leading Naturalist Camp.

3. What is the name of the park?

---

Continue walking down Lick Street for .2 of a mile. On the right is an old cemetery. Enter the cemetery and find Sally Robin's grave.

4. How old was Sally Robin when she died? \_\_\_\_\_

Leave the cemetery and walk south .5 of a mile to the first Intersection. Turn right to Hoag Road. Following Hoag Road for 1.7 miles notice the reforestation area on both side of the road. This is a State Forest that is an extension of Fillmore Glen State Park.

Turn right onto the first dirt road after you leave the woods. Follow this road for 1.2 miles. When you come to a crest in the road you will notice a lake to the northwest.

What is the name of the Lake?

---

Continue down the road. When you come to Tollgate Hill Road, turn right. On your left you will see a golf course.

6. What is the name of the golf course?

---

After following Tollgate Hill Road for .8 of a mile you will connect to Rt. 38. Turn right onto Route 38. Go .2 of a mile to Fillmore Glen State Park. Enter the Park and find the replica of Fillmore's cabin. Press the button and listen to the tape recording. With the aid of the recording answer the following questions.

7. Millard Fillmore was born how far from the Park?

---

8. Where did the family move to after 2 years?

---

9. What were the original dimensions of the cabin?

---

10. When was the cabin dedicated?

---

11. What year was Fillmore President of the U.S.?

---

12. Where did Millard Fillmore live most of his life?

---

13. Where is Fillmore buried? \_\_\_\_\_